



*speed klamp*



H A N D R A I L F I T T I N G S

# SLIP-ON SYSTEM

Size	A	B	C	D	E	kg
------	---	---	---	---	---	----

## SK3 90° ELBOW

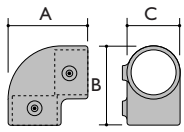

7	84	84	55			0.21
8	93	93	60			0.24

## SK5 90° TEE

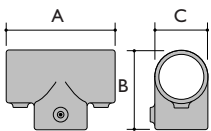

7	110	84	55			0.28
8	120	88	60			0.36

## SK5L 90° LIGHTWEIGHT TEE

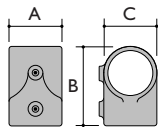

7	55	84	55			0.17
8	58	88	60			0.18

## SK7 CROSS

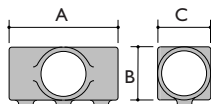

7	110	55	55			0.21
8	120	60	60			0.25

## SK9 90° SIDE OUTLET ELBOW

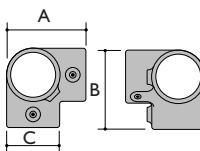

7	84	84	55			0.23
8	90	90	60			0.33

## SK11 SIDE OUTLET TEE

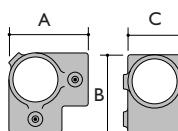

7	84	84	55			0.24
8	90	90	60			0.25

Size	A	B	C	D	E	kg
------	---	---	---	---	---	----

## SK17 ADJUSTABLE TEE

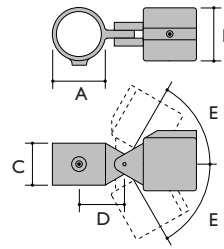

7	55	55	50	52	60°	0.35
8	60	60	51	51	60°	0.37

## SK19 ADJUSTABLE CROSS

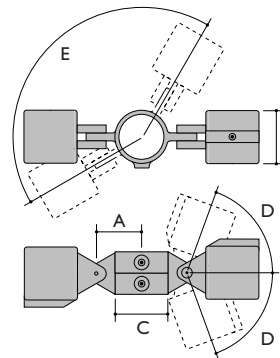

7	47	55	55	60°	120°	0.50
8	51	60	60	60°	120°	0.65

## SK30 DOUBLE SIDE OUTLET ELBOW/CROSS

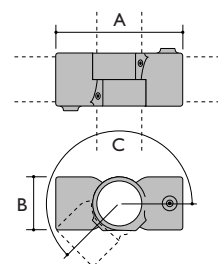

7	155	60	240°			0.63
8	175	72	240°			0.80

## SK41 ADJUSTABLE FLANGE

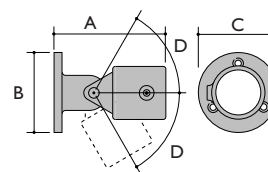

7	120	85	85	60°		0.32
8	120	85	85	60°		0.34

## SK43 WALL FLANGE

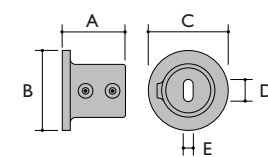

7	65	68	89	25	13	0.26
8	64	95	95	25	13	0.30

## SKTC TUBE END CAP ALUMINIUM/PLASTIC

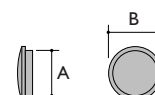

7	35	42				0.04
8	40	48				0.05

# BASES

	Size	A	B	C	D	E	kg
<b>SK46 BASE FLANGE 2 HOLE</b>	7	110	67	56	160		0.38
	8	112	72	64	167		0.42

	Size	A	B	C	D	E	kg
<b>SK48-2 BASE FLANGE 2 HOLE</b>	7	76	75	54	103		0.51
	8	115	90	115	155		0.60

	Size	A	B	C	D	E	kg
<b>SK48-4 BASE FLANGE 4 HOLE</b>	7	76	75	54	103	48	0.60
	8	130	90	115	155	65	0.70

	Size	A	B	C	D	E	kg
<b>SK49-2 BASE FLANGE 2 HOLE</b>	7	126	67	56	160		0.40
	8	112	72	64	167		0.46

Can be provided plain undrilled

	Size	A	B	C	D	E	kg
<b>SK49-4 BASE FLANGE 4 HOLE</b>	7	126	67	56	160	34	0.40
	8	112	72	64	167	50	0.46

	Size	A	B	C	D	E	kg
<b>SK50 DELTA SIDE BRACKET</b>	7	110	30	52	77	62	0.28
	8	160	37	60	91	95	0.62

	Size	A	B	C	D	E	kg
<b>SK51 CIRCULAR BASE FLANGE</b>	8	128	105	128			0.60

	Size	A	B	C	D	E	kg
<b>SK52-2 SIDE MOUNTED BRACKET 2 HOLE</b>	8	95	120	125	90	80	0.82

14 dia. Holes  
Note: dimension 'C' can be varied

	Size	A	B	C	D	E	kg
<b>SK52-3 SIDE MOUNTED BRACKET 4 HOLE</b>	8	95	120	125	90	80	0.82

14 dia. Holes  
Note: dimension 'C' can be varied

	Size	A	B	C	D	E	kg
<b>SK52-4 SIDE MOUNTED BRACKET 2 PIECE</b>	8	95	120	50	90		0.66

	Size	A	B	C	D	E	kg
<b>SK53-2 SIDE MOUNTED BRACKET 2 HOLE</b>	7	35	140	125	110		0.68
	8	35	166	125	110		0.79

Note: dimension 'C' can be varied

	Size	A	B	C	D	E	kg
<b>SK53-3 SIDE MOUNTED BRACKET 2 PIECE</b>	7	35	160	50	110		0.54
	8	35	166	50	110		0.64

# INLINE, EASYFIX AND OFFSET SYSTEMS

	Size	A	B	C	D	E	kg
--	------	---	---	---	---	---	----

## SKIL-1A TEE JOINT

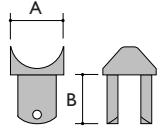

Also available in 316 stainless steel

8	48	45					0.16
							0.20

## SKIL-1C CROSS JOINT

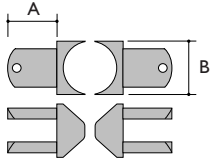

8	50	48					0.37
---	----	----	--	--	--	--	------

## SKIL-ET EXPANSION TEE

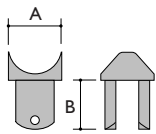

8	48	45					0.09
---	----	----	--	--	--	--	------

## SKIL-EC EXPANSION CROSS

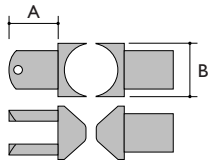

8	45	48					0.18
---	----	----	--	--	--	--	------

## SKIL-RT RAKING TEE

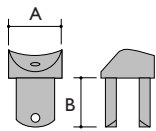

8	48	45					0.16
---	----	----	--	--	--	--	------

## SKIL-RC RAKING CROSS

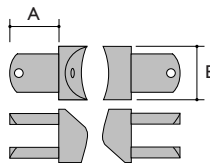

8	45	48					0.37
---	----	----	--	--	--	--	------

## SKEF-1 TEE BRANCH

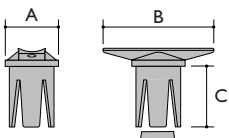

8	48	100	50				0.23
---	----	-----	----	--	--	--	------

## SKEF-3 ADJUSTABLE ARTICULATED TEE

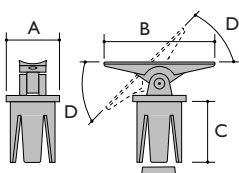

8	48	100	50	45°			0.29
---	----	-----	----	-----	--	--	------

	Size	A	B	C	D	E	kg
--	------	---	---	---	---	---	----

## SKIL-S180/90 180°-90° SWIVEL BEND

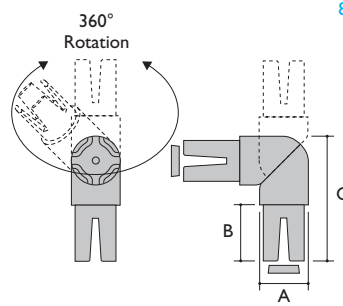

8	45	50	125				0.55
---	----	----	-----	--	--	--	------

## SKILH-90 90° HORIZONTAL ELBOW

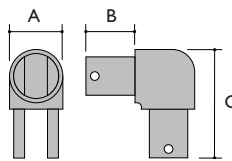

8	48	42	100				0.32
---	----	----	-----	--	--	--	------

## SKILT-90 90° TOP ELBOW

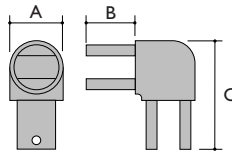

8	48	42	100				0.32
---	----	----	-----	--	--	--	------

## SKILB-90 90° BOTTOM ELBOW

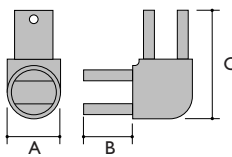

8	48	42	100				0.32
---	----	----	-----	--	--	--	------

## SKIL-135 135° ELBOW

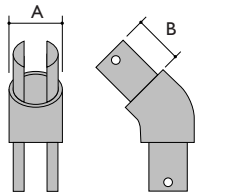

8	48	42					0.32
---	----	----	--	--	--	--	------

## SKOS-1 ADJUSTABLE OFFSET POST BRACKET

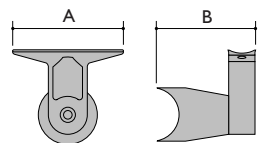

8	100	68					0.27
---	-----	----	--	--	--	--	------

## SKOS-2 ADJUSTABLE WALL BRACKET

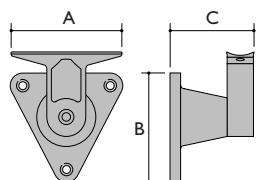

8	100	100	68				0.39
---	-----	-----	----	--	--	--	------

## ACCESSORIES

Size	A	B	C	D	E	kg
<b>SKGC-1 GLASS CLIP</b>						
7	60	60	12			0.10

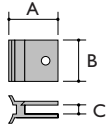

<b>SKMC1 MESH PANEL BRACKET</b>						
7	35	160	40	110		0.20
8	35	166	40	110		0.21

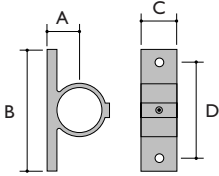

<b>SKIJ-7, IJ-8 INTERNAL JOINT</b>						
7	140	32				0.14
8	140	37				0.16

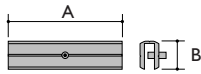

<b>SKBC-7, BC-8 BASE COWL</b>						
7	118	115				0.07
8	118	115				0.07

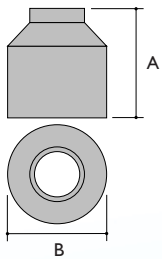

## WALLRAIL SYSTEM

To suit 38 dia. tube	A	B	C	D	E	kg
<b>SK82 OFFSET WALL BRACKET</b>						
	75	135	90	80	41	0.33

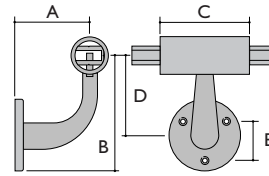

<b>SK83 WALL BRACKET</b>						
	75	90				0.30

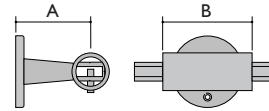

<b>SK84 RETURN BRACKET</b>						
	72	75	150			0.36

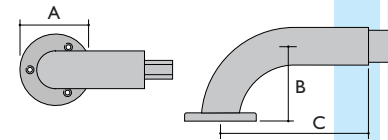

<b>SK86 END BRACKET</b>						
	75	72				0.21

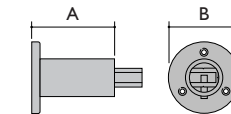

<b>SK88 TUBE CONNECTOR</b>						
	19	140				0.16

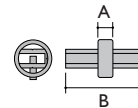

<b>SK90 90° CORNER</b>						
	150	300				0.43

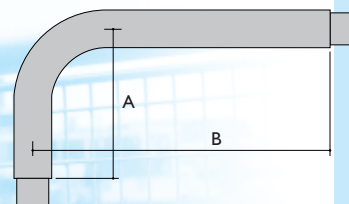

<b>SK92 FLANGE COVER FOR 84, 86</b>						
	74					0.01

Specify SK85 for 82, 83 and 94 Brackets

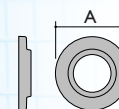

<b>Type 94 SUPPORT BRACKET</b>						
	75	55				0.17

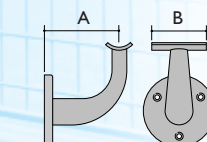

## GALVANISED STEEL & ALUMINIUM TUBE

### GALVANISED STEEL TO B.S. 1387

SK size	N. Bore mm	O.D. mm	Wall thickness		kg/metre	
			Heavy	Medium	Heavy	Medium
7	32	42.4	4.05	3.25	3.85	3.14
8	40	48.3	4.05	3.25	4.42	3.61

### ALUMINIUM TO B.S. 1474

SK size	N. Bore mm	O.D. mm	Wall thickness mm	kg/metre
7	32	42.4	3.25	1.08
8	40	48.3	3.63	1.39

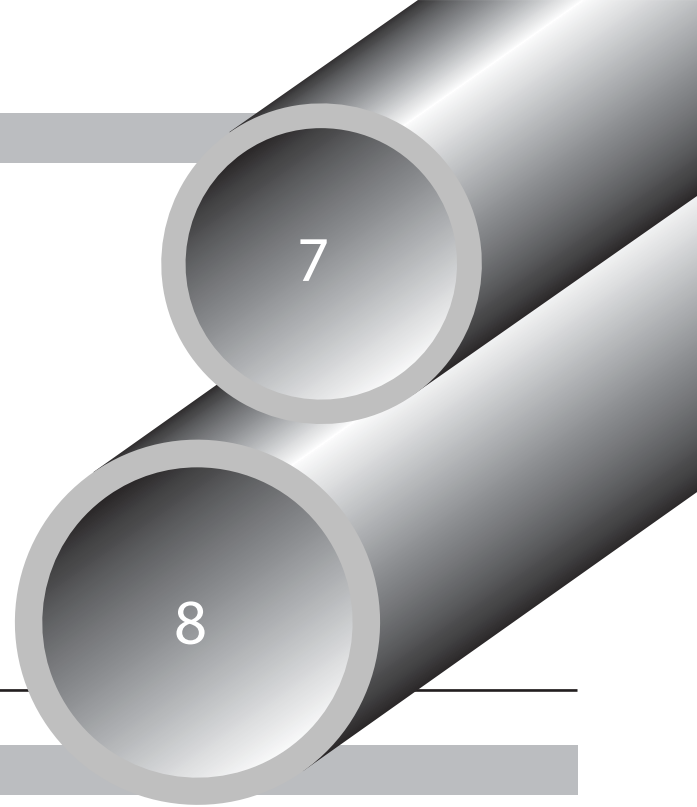

## VARIABLE GRADIENT SYSTEM

Speed Klamp variable angle fittings are intended to give greater flexibility in the design of disabled access ramps and to help eliminate inaccuracies of building tolerances in rake angles.

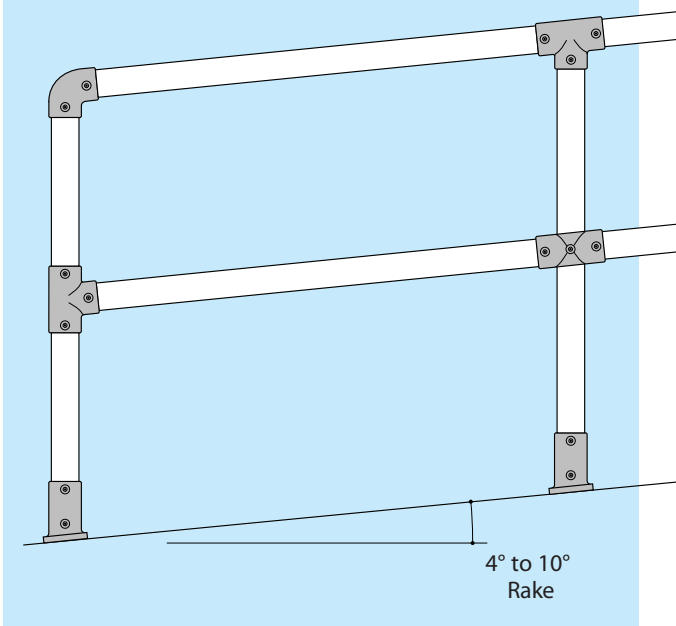

To suit 4° to 10° Rake

	Size	A	B	C	kg
<b>SKGE GRADIENT ELBOW</b>	8	100	100		0.35
<b>SKGT GRADIENT TEE</b>	8	120	95		0.36
<b>SKGC GRADIENT CROSS</b>	8	145	60	62	0.37
<b>SKGB GRADIENT BASE FLANGE</b>	8	103	150	76	0.37

In the interest of continued improvement we reserve the right to modify any products or specifications without prior notice. All sizes, weights and measures are approximate.



FM23434  
BS EN ISO 9001:2000



# HOLLAENDER RAINER

P.O. Box 52, Walsall, West Midlands, WS2 7PL, England  
Tel: +44 (0)1922 711474 Fax: +44 (0)1922 497943  
E-mail: sales@hollaenderrainer.com  
web: www.hollaenderrainer.com

Contact: